

Scale 1:200
1958

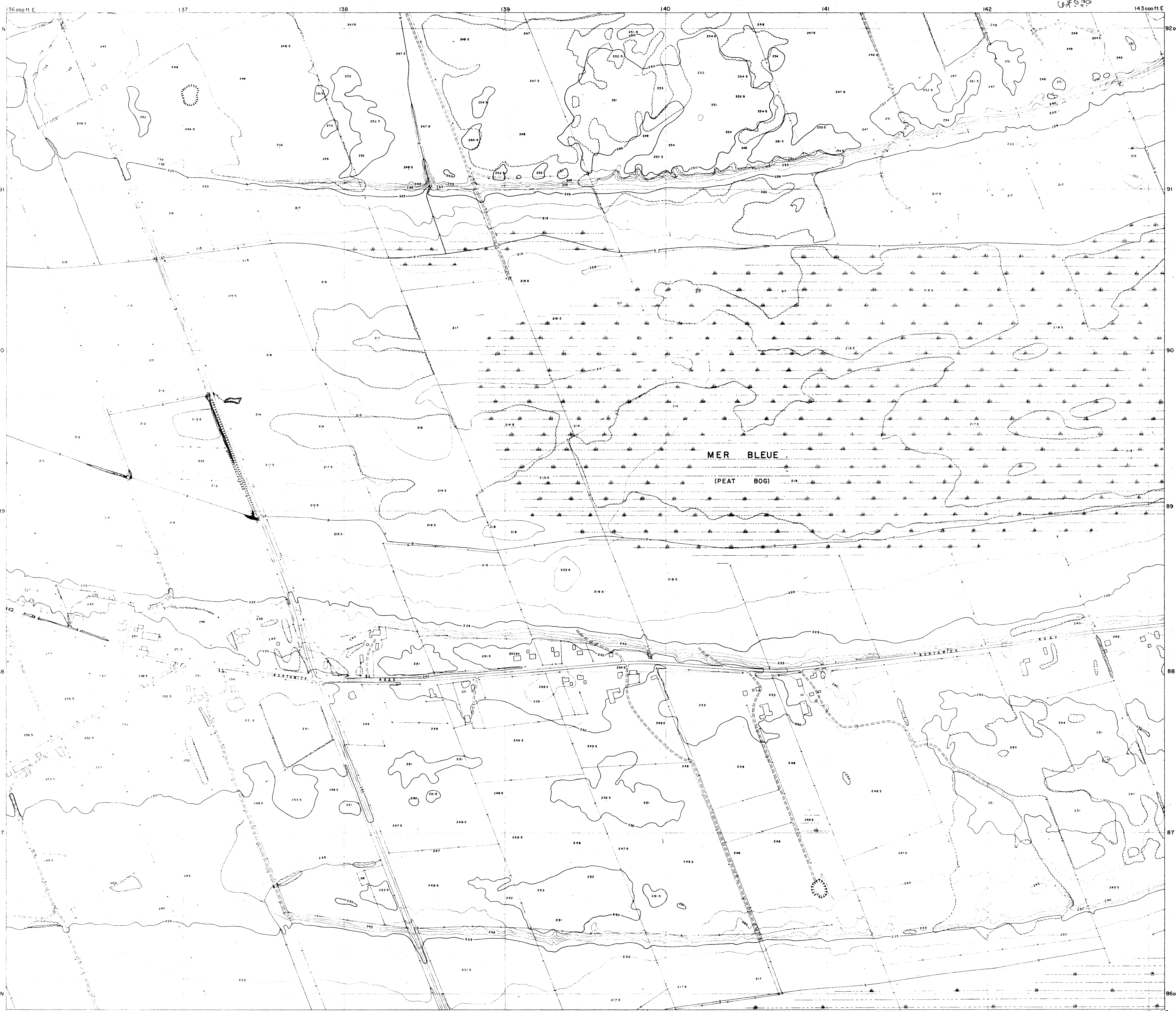

TOWNSHIP OF GLOUCESTER

SCALE: 200 FEET = 1 INCH



CONTOUR INTERVAL 5 FEET

INDEX TO ADJOINING SHEETS

SHEET NO. SHEET 014	SHEET NO. SHEET 016
SHEET NO. SHEET 013	SHEET NO. SHEET 017
SHEET NO. SHEET 012	SHEET NO. SHEET 018

LEGEND

ROADS DEFINED	UNDEFINED	CANAL	SWAMP	EMBANKMENT	CUTTING	CLIFF	TREES	DEPRESSION CONTOUR
TRACK	FOOTPATH	RAILROAD	TRAMWAY	WATER OR STREAM	WALL	POWER TRANSMISSION LINE		

GENERAL INFORMATION

THIS MAP IS BASED ON THE TRANSVERSE MERCATOR PROJECTION THE GRID PARALLELS THE MILITARY U.T.M. METRIC GRID FOR THIS ZONE THE GRID NUMBERING IS BASED ON THE PEACE TOWER OF THE PARLIAMENT BUILDINGS, WHICH HAS BEEN GIVEN VALUES OF 100,000 FEET EAST AND 100,000 FEET NORTH GRID LINE SPACING IS 1000 FEET. GRID NORTH ON THIS SHEET IS 0° 23' 19" WEST OF TRUE NORTH.

FOR FURTHER INFORMATION ON THE DISPOSITION OF MAP SHEETS REFER TO SHEET INDEX DIAGRAM GIVEN AS A SEPARATE DRAWING

PREPARED FOR THE NATIONAL CAPITAL COMMISSION

COMPILED BY SPARTAN AIR SERVICES LIMITED, BY PHOTOGRAMMETRIC METHODS, FROM AERIAL PHOTOGRAPHY BY SPARTAN AIR SERVICES LIMITED, NOVEMBER 1958