

66000 ft. E. 67 68 69 70 71 72 73000 ft. E

68000 ft. N. 67 66 65 64 63 62000 ft. N.

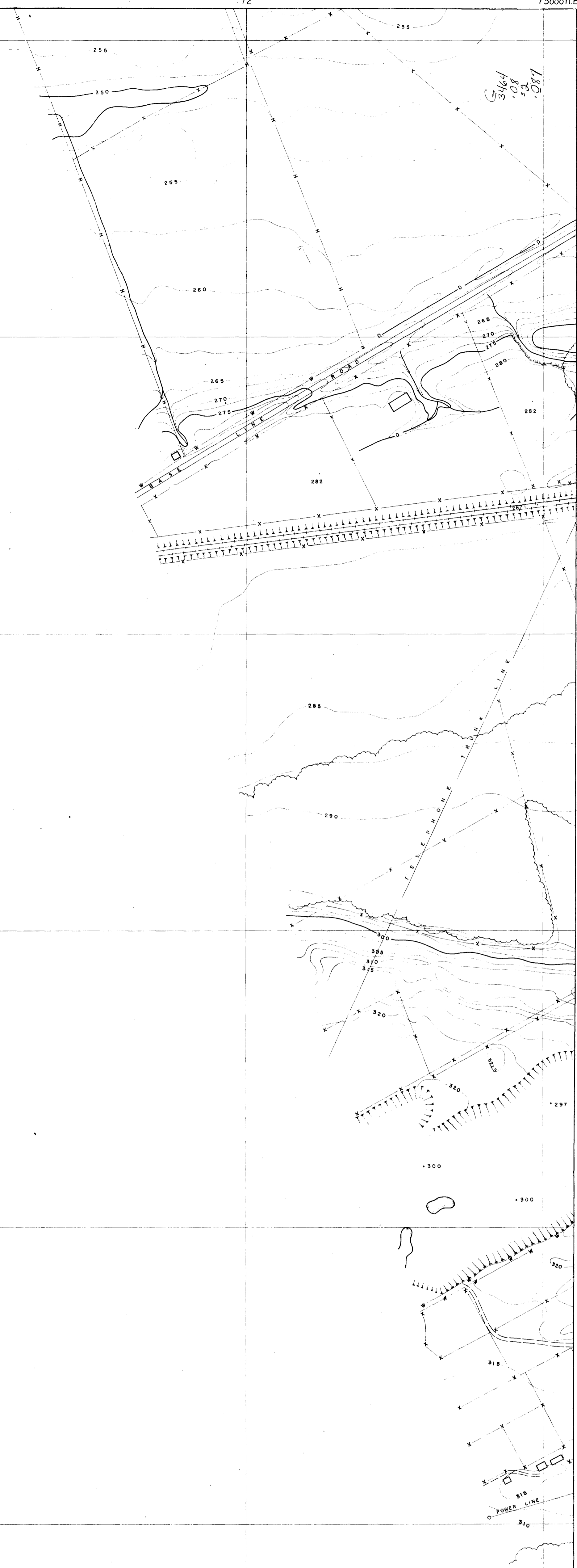

INDEX TO ADJOINING SHEETS

SHEET	SHEET E I	SHEET F I
SHEET	SHEET E II	SHEET F II
SHEET	SHEET	SHEET

LEGEND

ROADS DEFINED	UNDEFINED	TRACK	FOOTPATH	RAILROAD	TRAMWAY	RIVER OR STREAM	CANAL	SWAMP	DITCH	HEDGE	WALL	POWER TRANSMISSION LINE	EMBANKMENT	CUTTING	CLIFF	TREES	DEPRESSION CONTOUR
.....

CITY OF OTTAWA AND ENVIRONS

SCALE: 200 FEET = 1 INCH

CONTOUR INTERVAL 5 FEET WITH 2 1/2 FEET INTERPOLATION

GENERAL INFORMATION

THIS MAP IS BASED ON THE TRANSVERSE MERCATOR PROJECTION.

THE GRID PARALLELS THE MILITARY U. T. M. METRIC GRID FOR THIS ZONE.

THE GRID NUMBERING IS BASED ON THE PEACE TOWER OF THE PARLIAMENT BUILDINGS, WHICH HAS BEEN GIVEN VALUES OF 100,000 FEET EAST AND 100,000 FEET NORTH. GRID LINE SPACING IS 1000 FEET. GRID NORTH ON THIS SHEET IS 0° 31' 29" WEST OF TRUE NORTH.

FOR FURTHER INFORMATION ON THE DISPOSITION OF MAP SHEETS REFER TO SHEET INDEX DIAGRAM GIVEN AS A SEPARATE DRAWING.

PREPARED FOR THE CORPORATION OF THE CITY OF OTTAWA AND THE FEDERAL DISTRICT COMMISSION

COMPILED BY A.E. SIMPSON LTD. AND SHAW PHOTOGRAMMETRIC SERVICES, FROM AERIAL PHOTOGRAPHY BY A.E. SIMPSON LTD. DATED NOVEMBER 1957

SHEET No: E II

Universit  d'Ottawa
Cartoth que
1969
Universit  of Ottawa
Map Library

REFERENC