

N.C.C. LANDS
PT. LOT 25 CON 2, (OF)

N.C.C. LANDS
PT. LOT 24 CON 2, (OF)

C FORMER C.N.R. RIGHT-OF-WAY

QUEENSWAY

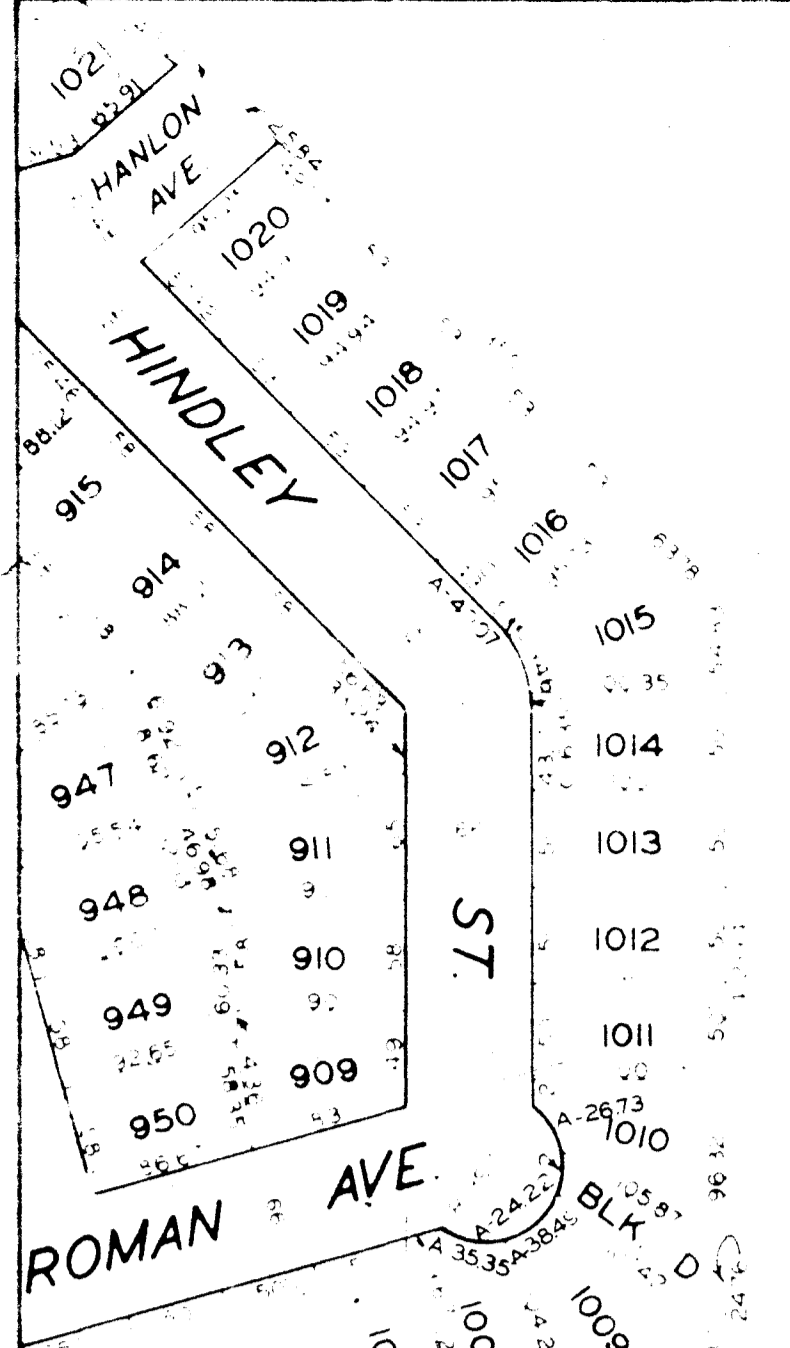

544
08
51
08

SHEET (H-1)

CORPORATION OF THE CITY OF OTTAWA
ENGINEERING DEPARTMENT-LEGAL SURVEYS BRANCH

SHEET H-1

SCALE 1"=100'

COPYRIGHT, CANADA, SERIAL NO. 181982

15 AUG 68

G-1-A	G-1	G-2
H-1-A	H-1	H-2
I-1-A	I-1	I-2

THIS PLAN IS A PRELIMINARY SURVEY AND IS NOT TO BE USED FOR CONSTRUCTION OR AS EVIDENCE IN COURT. THE EXACT LOCATION OF THE BOUNDARIES AND THE AREA OF THE LOTS MAY BE FOUND UPON A MORE DETAILED SURVEY.

G. MacKnight

H-1