

5/14
100
5/8
SHEET D-12

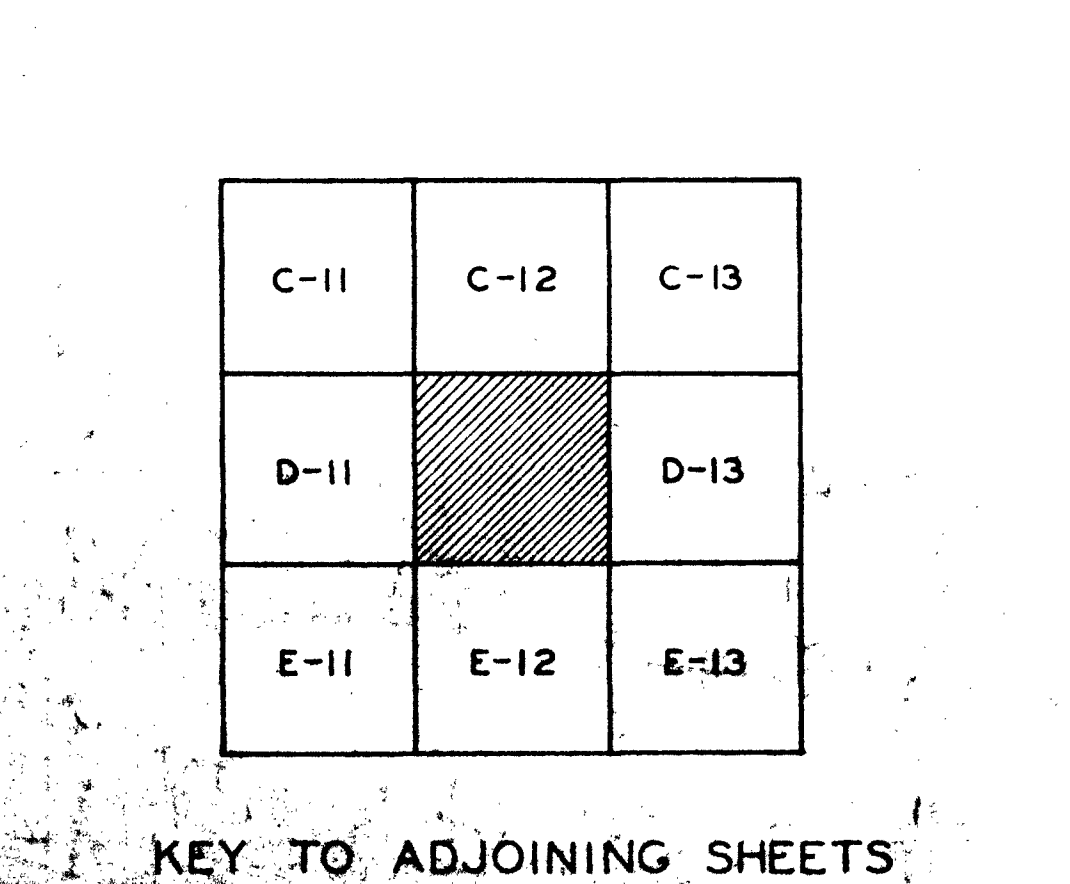
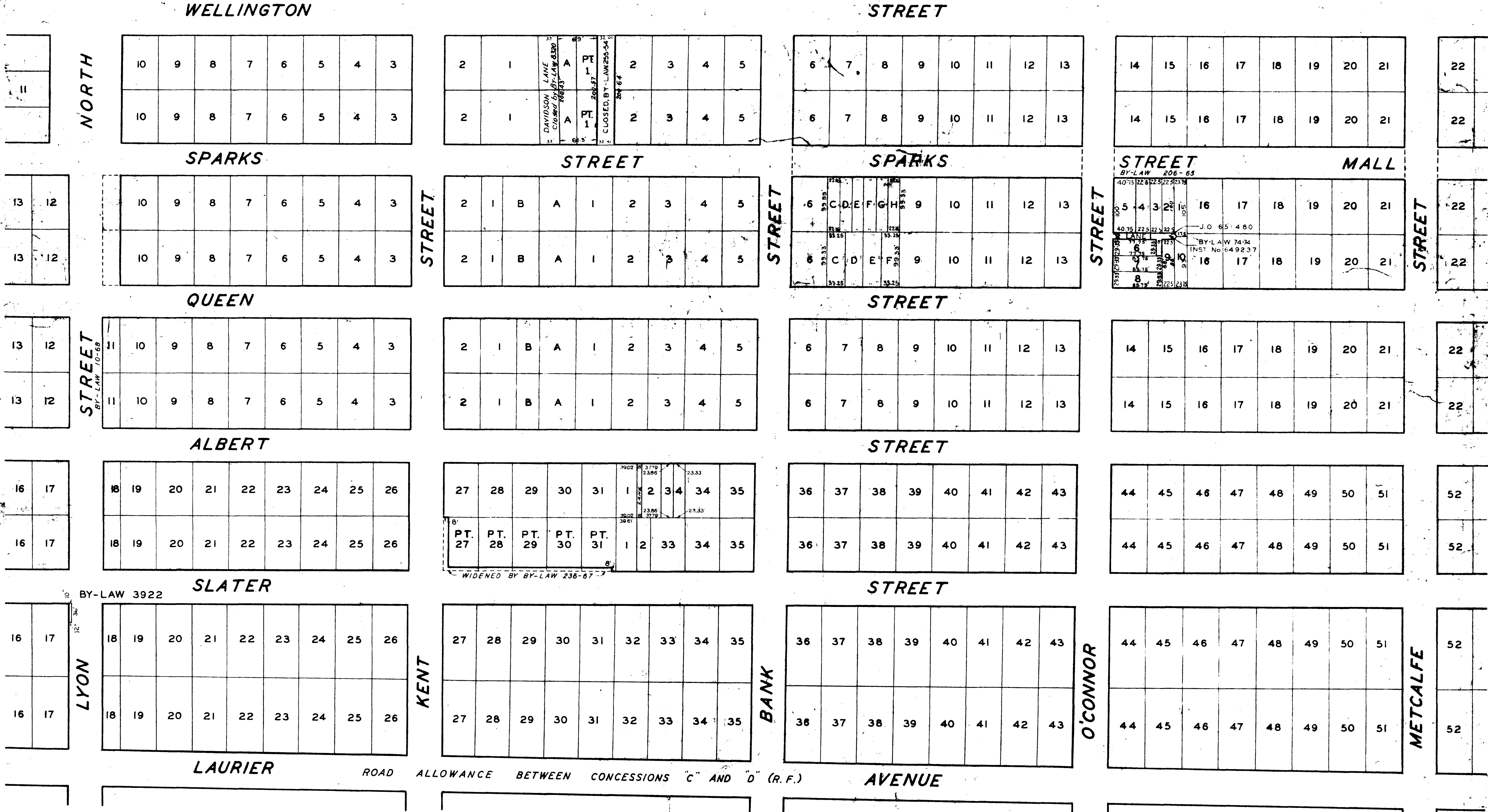
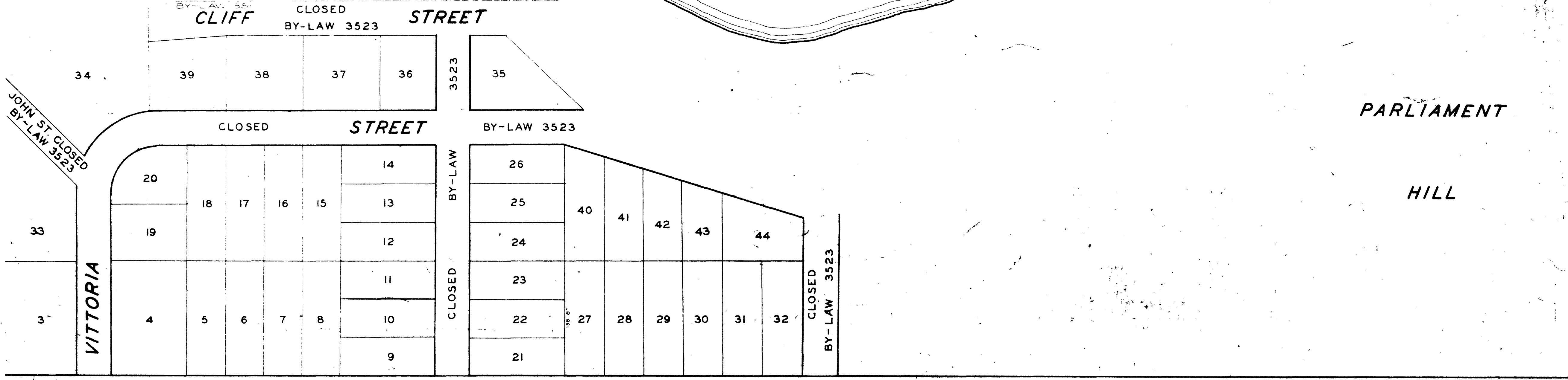
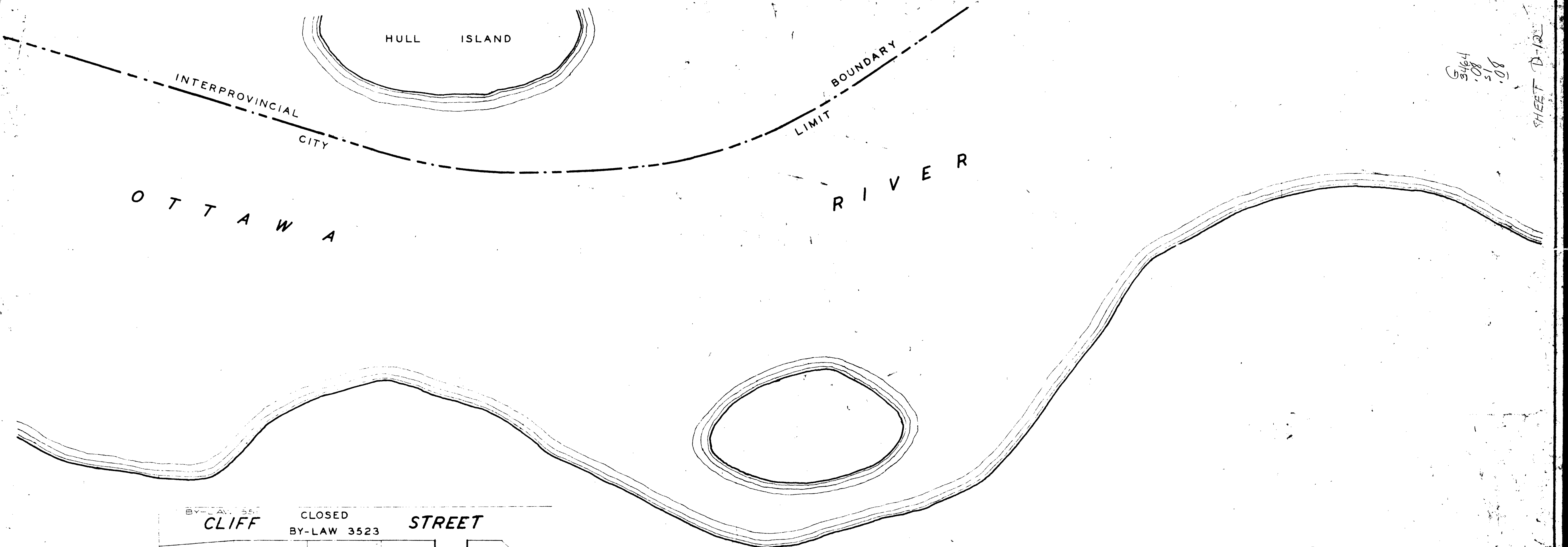

— CORPORATION OF OTTAWA —
ENGINEERING DEPARTMENT - LEGAL SURVEYS BRANCH

SHEET D-12

— PLAN OF CITY OF OTTAWA —
SCALE — 100' = 1" —

COPYRIGHT, CANADA, SERIAL NO. 181982

THIS PLAN IS COMPILED FROM REGISTERED PLANS WITH THE ASSISTANCE OF A MINIMUM OF FIELD SURVEY. MOST MEASUREMENTS SHOWN HEREON HAVE BEEN TAKEN FROM SUCH PLANS OR FROM DEEDS OR BY-LAWS AND THEY ARE NOT INTENDED TO DENY THE EXISTENCE OF EITHER SURPLUS OR DEFICIENCY WHICH MAY BE FOUND UPON A MORE DETAILED SURVEY.

PREPARED BY SURVEY BRANCH 1947

APPROVED BY *F.O. Whitt*
COMMISSIONER OF WORKS

DATE FEB. 27, 1947

NOTE -
LOT SIZES ARE OMITTED AS REGISTERED PLAN NUMBER 3922 DOES NOT GIVE MEASUREMENTS, AND WHILE THE LOTS NORTH OF SLATER STREET WERE PROBABLY INTENDED TO BE 66' x 99', CONSIDERABLE VARIATIONS EXIST.