

Called  
208  
508  
SHEET D-12

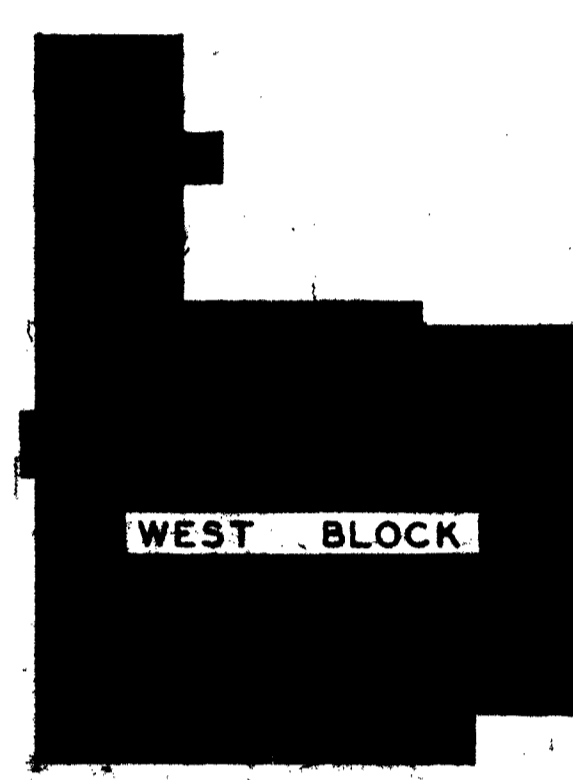

PARLIAMENT HILL

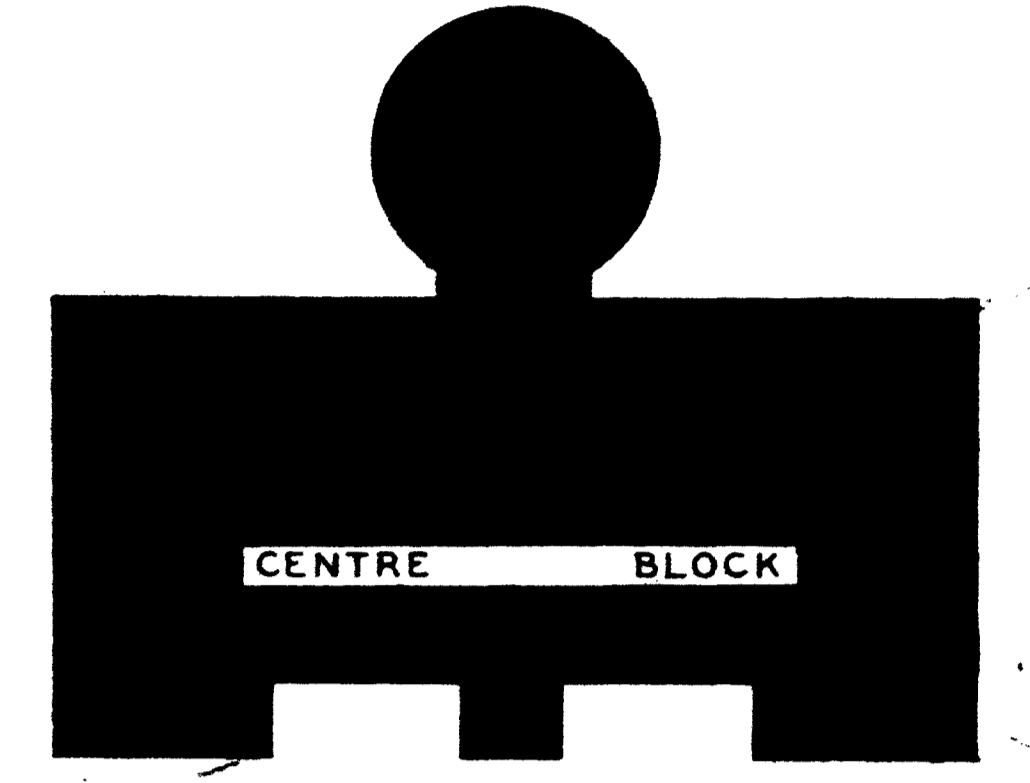
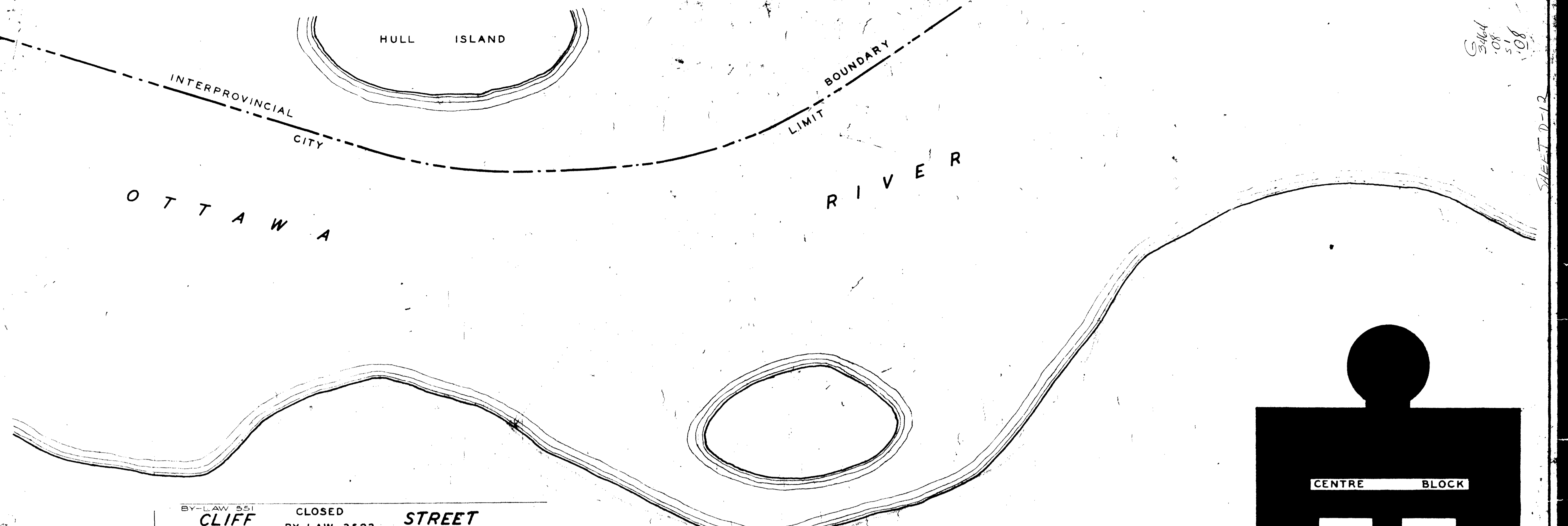
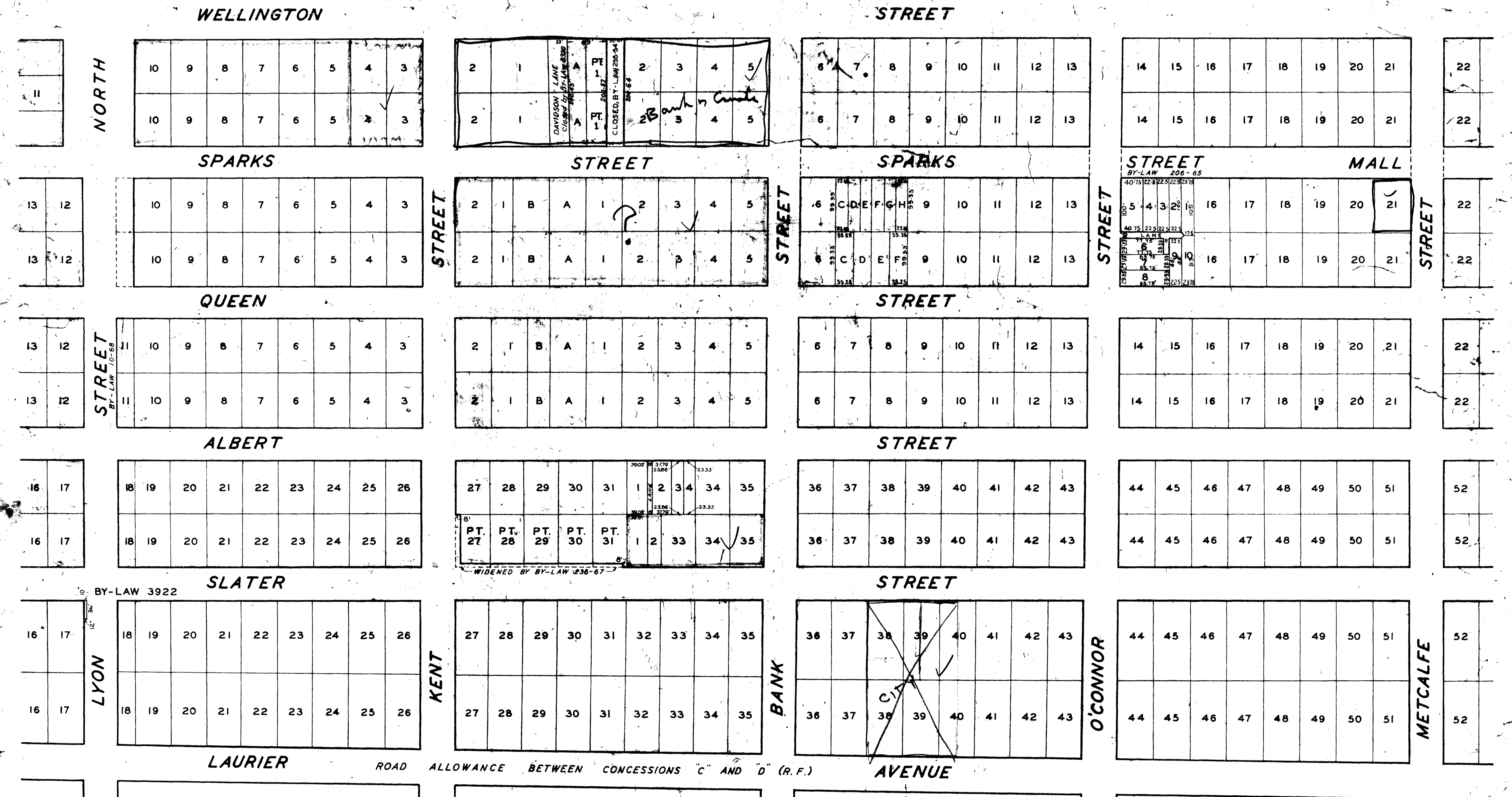
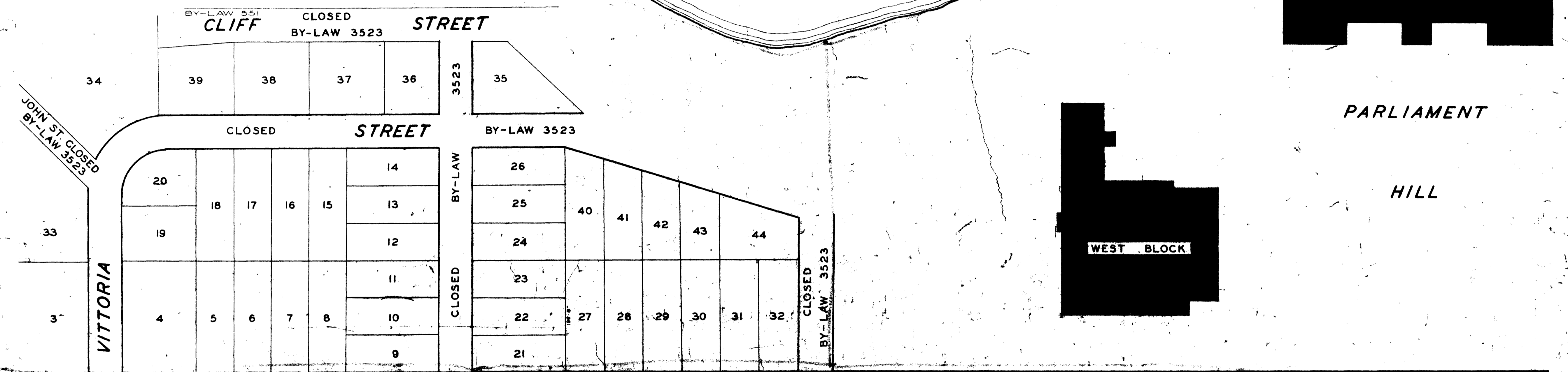

CORPORATION OF OTTAWA  
ENGINEERING DEPARTMENT - LEGAL SURVEYS BRANCH

SHEET D-12

PLAN OF CITY OF OTTAWA  
SCALE 100 = 1

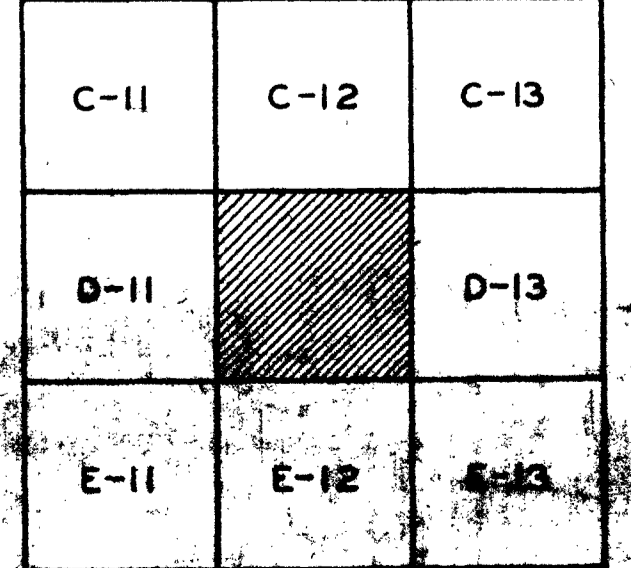

NOTE -  
LOT SIZES ARE OMITTED AS REGISTERED PLAN NUMBER 3922 DOES NOT GIVE MEASUREMENTS, AND WHILE THE LOTS NORTH OF SLATER STREET WERE PROBABLY INTENDED TO BE 66' x 99', CONSIDERABLE VARIATIONS EXIST  
Dec 20/72  
Federal land Ownership  
checked x Dec map.

THIS PLAN IS COMPILED FROM REGISTERED PLANS AND SURVEYS AND IS NOT A FIELD SURVEY. IT IS THE RESPONSIBILITY OF THE SURVEYOR TO VERIFY THE ACCURACY OF THE INFORMATION PROVIDED. THE CORPORATION OF OTTAWA ACCEPTS NO LIABILITY FOR ANY LOSS OR DAMAGE TO ANY PROPERTY OR PERSONS ARISING FROM THE USE OF THIS PLAN.  
COPYRIGHT: CANADA SERIAL NO. 161982  
PREPARED BY SURVEY BRANCH APPROVED BY [Signature]  
COMMISSIONER OF WORKS

KEY TO ADJOINING SHEETS