

Sheet D-11
101
108

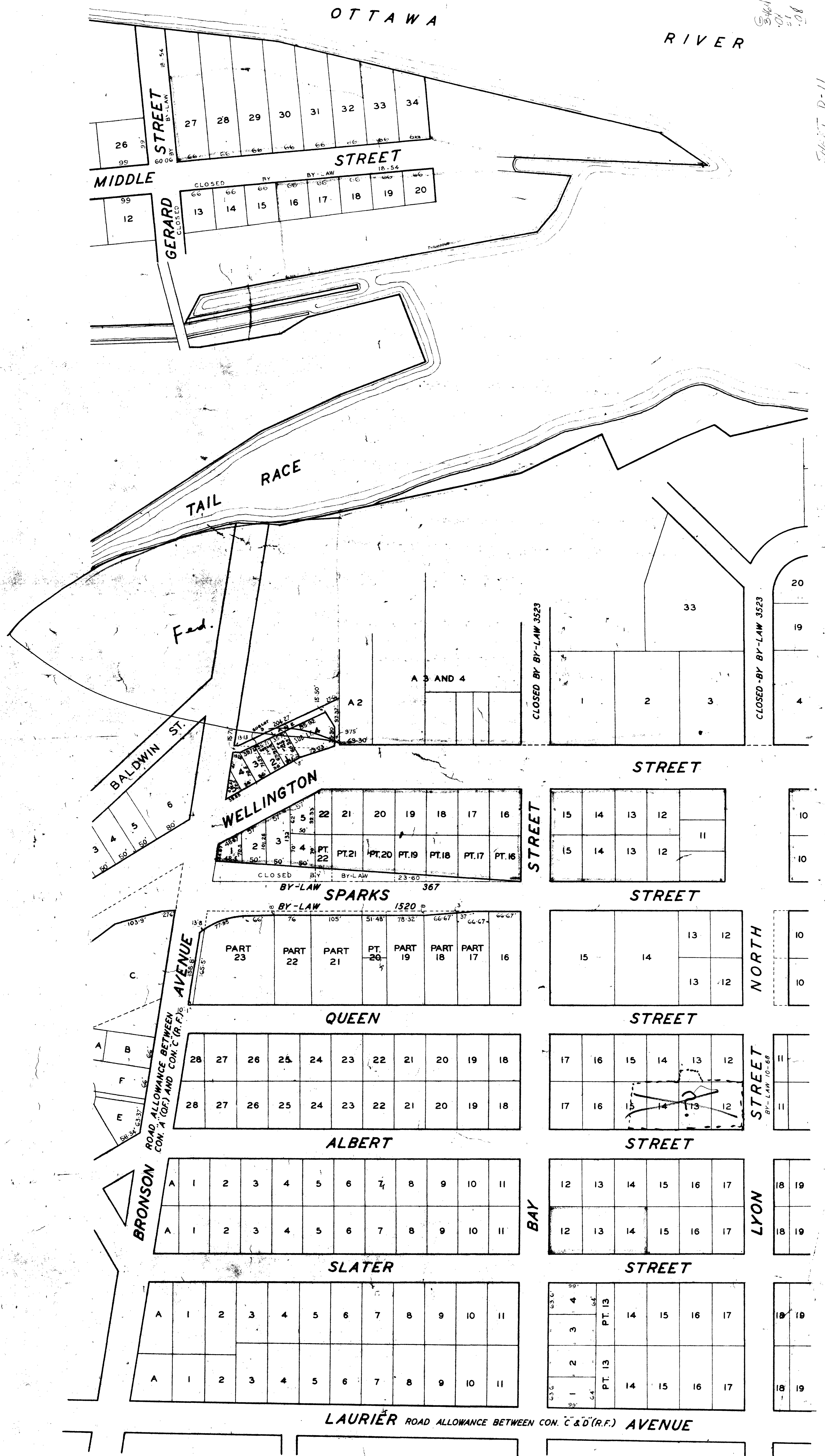

CORPORATION OF OTTAWA
ENGINEERING DEPARTMENT - LEGAL SURVEYS BRANCH

SHEET D-II

PLAN OF CITY OF OTTAWA
SCALE 100' = 1"

COPYRIGHT, CANADA, SERIAL NO. 181982

C-10	C-11	C-12
D-10		D-12
E-10	E-11	E-12

KEY TO ADJOINING SHEETS

THIS PLAN IS COMPILED FROM REGISTERED PLANS WITH THE ASSISTANCE OF A MINIMUM OF FIELD SURVEY. MOST MEASUREMENTS SHOWN HEREON HAVE BEEN TAKEN FROM SUCH PLANS OR FROM DEEDS OR BY-LAWS AND THEY ARE NOT INTENDED TO DENY THE EXISTENCE OF EITHER SURPLUS OR DEFICIENCY WHICH MAY BE FOUND UPON A MORE DETAILED SURVEY.

PREPARED BY SURVEY BRANCH 1947

APPROVED BY
[Signature]
COMMISSIONER OF WORKS
DATE MARCH 23, 1952

NOTE -
LOT SIZES ARE OMITTED AS REGISTERED PLAN 3922 DOES NOT GIVE MEASUREMENTS, AND WHILE THE LOTS NORTH OF SLATER STREET WERE PROBABLY INTENDED TO BE 66' X 99', CONSIDERABLE VARIATIONS EXIST.

*Checked & Navys De 20/52
for Fed. Land Jurisdiction*